

ISO 45 & HSK Extension holder for Structural

ISO45

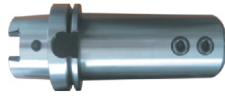

HSK



- ▶ ISO 45(HSK) holder can help drilling with strong rigidity
- ▶ Internal coolant channel structure
- ▶ Side locking with two set screws
- ▶ Ideal holder to run KRUZ-SLK body & IDFK insert
- ▶ HSK holder is available upon request

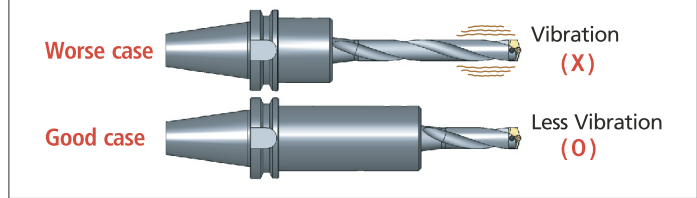
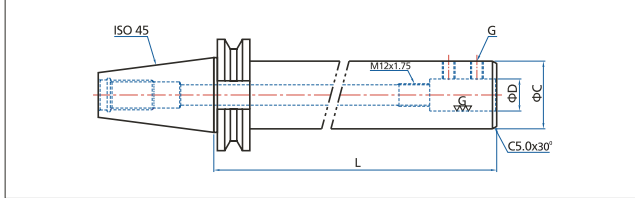

Indexable, Coolant Drill Series

CODE No.	D	L	C	G
ISO45(HSK)-SLA16-80	16	80	56	M10
ISO45(HSK)-SLA16-160		160		
ISO45(HSK)-SLA16-210		210		
ISO45(HSK)-SLA16-240		240		
ISO45(HSK)-SLA16-270		270		
ISO45(HSK)-SLA16-300		300		
ISO45(HSK)-SLA16-350		350		
ISO45(HSK)-SLA16-400		400		
ISO45(HSK)-SLA16-450		450		
ISO45(HSK)-SLA16-500		500		
ISO45(HSK)-SLA20-80	20	80	56	M12
ISO45(HSK)-SLA20-160		160		
ISO45(HSK)-SLA20-210		210		
ISO45(HSK)-SLA20-240		240		
ISO45(HSK)-SLA20-270		270		
ISO45(HSK)-SLA20-300		300		
ISO45(HSK)-SLA20-350		350		

CODE No.	D	L	C	G
ISO45(HSK)-SLA20-400	20	400	56	M12
ISO45(HSK)-SLA20-450		450		
ISO45(HSK)-SLA20-500		500		
ISO45(HSK)-SLA25-80	25	80	56	M12
ISO45(HSK)-SLA25-160		160		
ISO45(HSK)-SLA25-210		210		
ISO45(HSK)-SLA25-240		240		
ISO45(HSK)-SLA25-270		270		
ISO45(HSK)-SLA25-300		300		
ISO45(HSK)-SLA25-350		350		
ISO45(HSK)-SLA25-400		400		
ISO45(HSK)-SLA25-450		450		
ISO45(HSK)-SLA25-500		500		
ISO45(HSK)-SLA32-80	32	80	56	M14
ISO45(HSK)-SLA32-160		160		
ISO45(HSK)-SLA32-210		210		
ISO45(HSK)-SLA32-240		240		

CODE No.	D	L	C	G
ISO45(HSK)-SLA32-270	32	270	56	M12
ISO45(HSK)-SLA32-300		300		
ISO45(HSK)-SLA32-350		350		
ISO45(HSK)-SLA32-400		400		
ISO45(HSK)-SLA32-450		450		
ISO45(HSK)-SLA32-500	500			
ISO45(HSK)-SLA40-90	40	90	60	M14
ISO45(HSK)-SLA40-160		160		
ISO45(HSK)-SLA40-210		210		
ISO45(HSK)-SLA40-240		240		
ISO45(HSK)-SLA40-270		270		
ISO45(HSK)-SLA40-300		300		
ISO45(HSK)-SLA40-350		350		
ISO45(HSK)-SLA40-400		400		
ISO45(HSK)-SLA40-450		450		
ISO45(HSK)-SLA40-500		500		

* Pull stud bolt not included in the above holder.
 * ISO40 holder is available upon request.